

THE CORPORATION OF THE COUNTY OF PERTH

BY-LAW NUMBER 3443-2015

TO ADOPT AMENDMENT NO. 144 TO THE COUNTY OF PERTH OFFICIAL PLAN

The Council of the Corporation of the County of Perth in accordance with the provisions of Sections 17 and 21 of the Planning Act, R.S.O. 1990 hereby enacts as follows:

1. Amendment No. 144 to the County of Perth Official Plan, consisting of the attached text and schedules, is hereby adopted.
2. That the Clerk is hereby authorized and directed to proceed with the giving of written notice of the County's decision in accordance with the provisions of the Planning Act, R.S.O. 1990.
3. This By-law shall come into force and take effect on the day of the final passing thereof.

Read a first and second time this 15th day of January, 2015

Read a third time and finally passed this 15th day of January, 2015

Original Signed by
Robert Wilhelm, Warden

Original Signed by
Kerri Ann O'Rourke, Clerk

PART B - THE AMENDMENT

All of this document entitled "Part B - The Amendment" consisting of the attached map, designated Schedule "A-144" (Land Use Plan), constitutes Amendment No. 144 to the County of Perth Official Plan.

DETAILS OF THE AMENDMENT

The County of Perth Official Plan is hereby amended as follows:

Item 1:

By amending Schedule "A" - Land Use Plan as follows:

(i) The land use designation for the lands described as part of Lot 20, Concession 1 in the North Easthope Ward of the Township of Perth East (shown in hatching on Schedule "A-144" attached hereto) shall be changed from "Agriculture" to "Serviced Urban Area".

Item 2:

By placing the subject lands within the "SERVICED URBAN AREA" and "Residential" designation on Schedule "A6-2" (Shakespeare).

SCHEDULE 'A-144' - LAND USE PLAN AMENDMENT NO. 144 TO THE PERTH COUNTY OFFICIAL PLAN

NORTH EASTHOPE WARD

PERTH ROAD 107

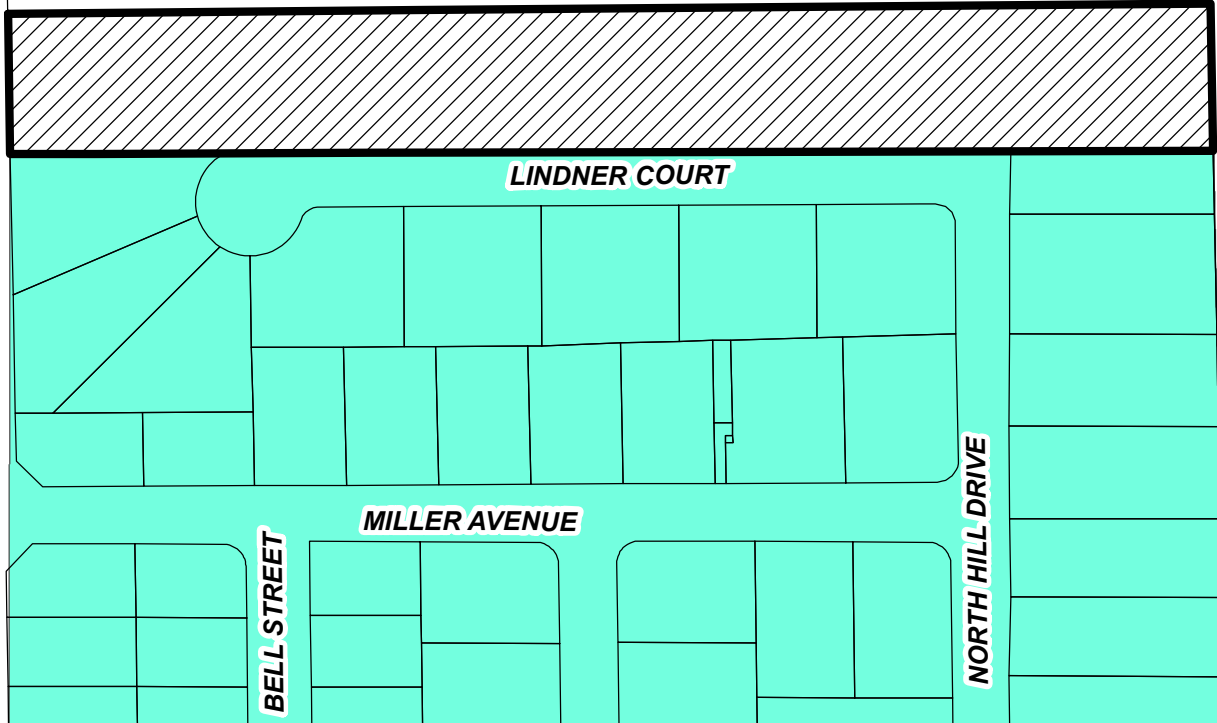

January-08-15



LAND SUBJECT TO OPA #144 (Change from 'Agriculture' to 'Serviced Urban Area')



NRE Adjacent Land/Buffer Area

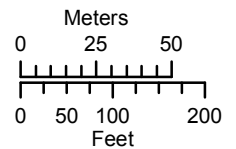

Coordinate System: NAD 1983 UTM Zone 17N
Projection: Transverse Mercator